

True
RESIDENTIAL
FULL SIZE FREEZER

36" Freezer (Right or Left Hinged) With
Solid Stainless Steel Door

Offering 19.1 cu ft of freezer space, the 36" Freezer Column is the most flexible, functional, and unique True freezer to date. Perfect for large families and regular hosts, the Freezer Column is sized to fit into any space and to perfectly preserve all the proteins, produce, and party goods you could possibly need.

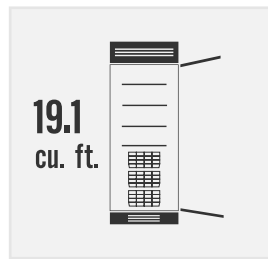
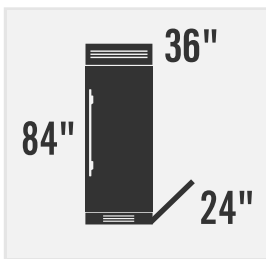

TR-36FRZ-R-SS-A & TR-36FRZ-L-SS-A,
36" Freezer (Right or Left Hinged)
With Solid Stainless Steel Door



TR-36FRZ-R-SS-A
Door Closed

EXCEPTIONAL FEATURES

Industry exclusive, 300-series stainless steel interior and exterior. Stainless steel interior is antibacterial, hygienic, easy to clean, and does not retain food odors.

All stainless steel, beautifully crafted proud hinges pass True's rigorous one million door opening test.

Beautifully crafted solid stainless steel door with 120° stay-open feature and ergonomically designed, robust, tubular handles.

Commercially inspired lift-up grill on top of the unit with toe kick that complements the look of True's undercounter units.

Ramp-up, showcase interior LED lighting provides amazing illumination throughout.

Low-E, triple pane, tinted glass on glass door models.

Intuitive True Precision® Control and readout provides digital accuracy and easy operation.

Balanced, forced-air refrigeration system enables proper airflow and even temperature throughout to keep frozen food fresh.

Temperature as low as -4°F.

ORGANIZATION

3 electro-polished stainless steel shelves.

3 full-extension, soft-close wire baskets.

OPTIONAL ACCESSORIES

Side panels - Required for exposed side installation.

66" joining kit - 66" cohesive grill & toe kick when installing 30inch column next to a 36" column.

72" joining kit - 72" cohesive grill & toe kick when installing 36inch together.

ELECTRICAL SPECIFICATIONS

Voltage: 115/60/1

Amps: 3.2

Power Cord Length: 9'

Annual kWh Consumption: 466



PLAN VIEW

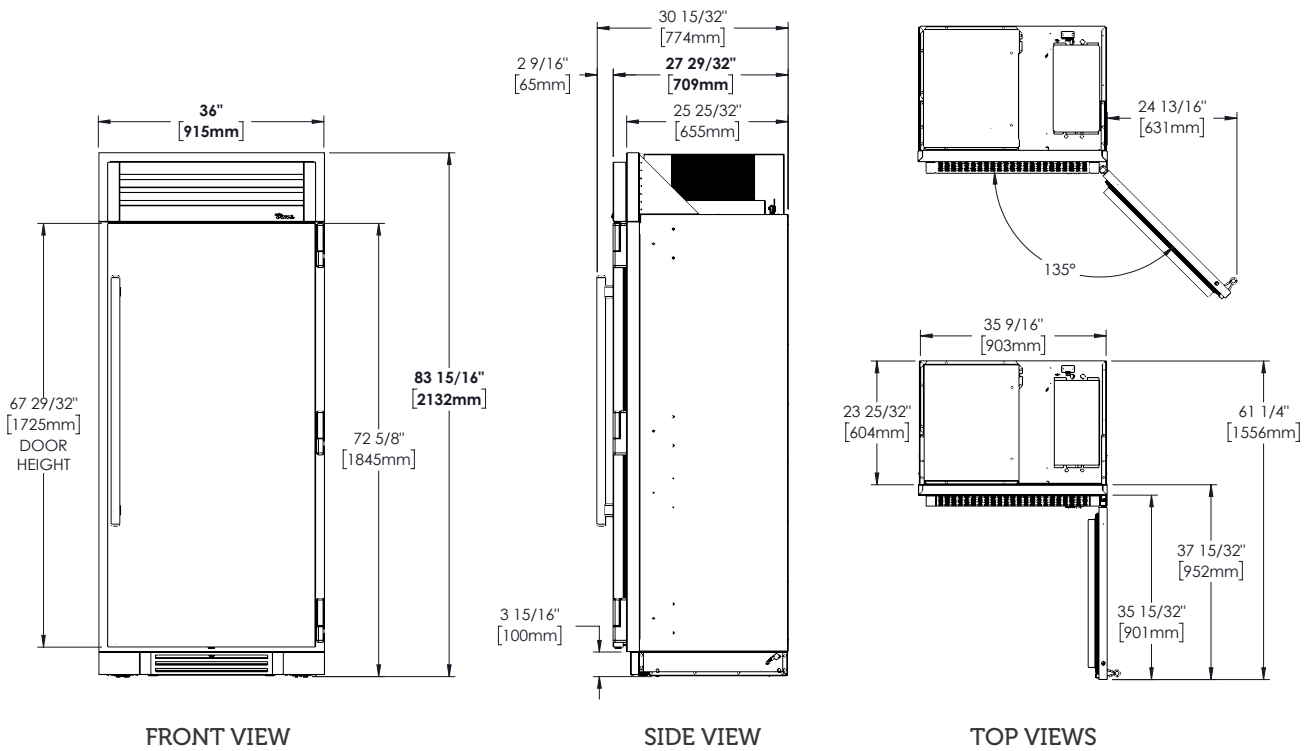

Dimensions may vary by ± 1/8"

FLUSH OPENING DIMENSIONS

| Width | Depth† | Height |
|---------|--------|---------|
| 36 1/4" | 26" | 84 1/4" |

TOP VIEW
FIGURE 1 ROUGH OPENING

PROUD OPENING DIMENSIONS

| Width | Depth† | Height |
|---------|--------|--------|
| 35 3/4" | 24" | 84" |

FRONT VIEW
FIGURE 2 ROUGH OPENING

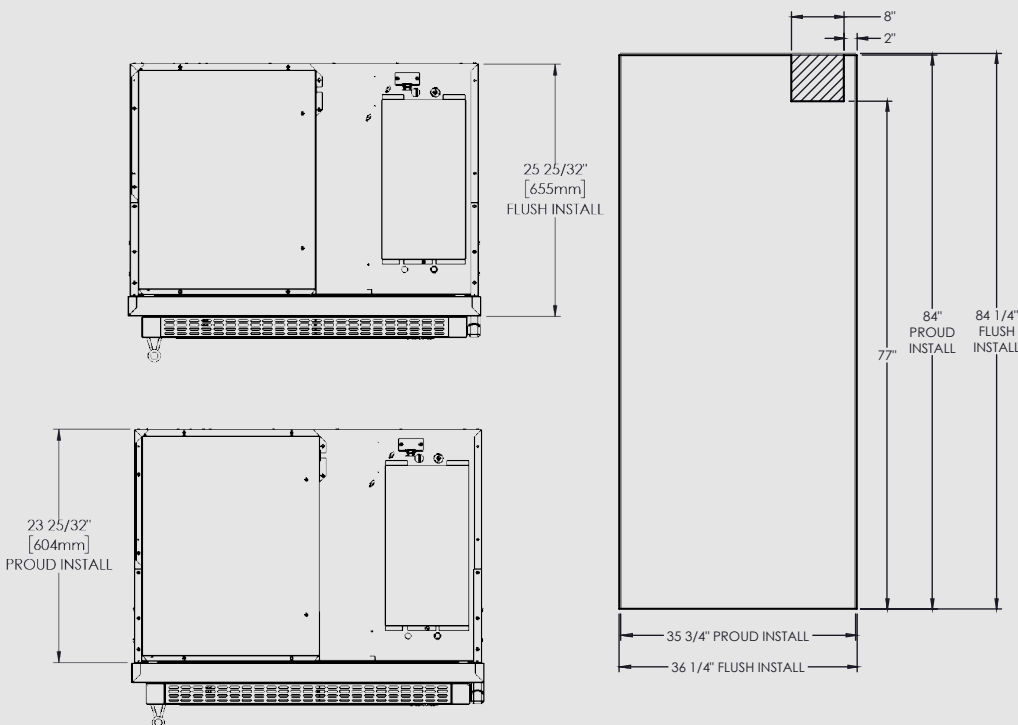

SPECIFICATIONS

| | |
|----------------------|--|
| Width | 36" |
| Depth† | 28" |
| Height | 84" |
| Shelving | 4 electro-polished stainless steel shelves. 3 full-extension, soft-close wire bins. |
| Flush Opening Width | 36 1/4" |
| Flush Opening Depth | 26" |
| Flush Opening Height | 84 1/4" |
| Proud Opening Width | 35 3/4" |
| Proud Opening Depth | 24" |
| Proud Opening Height | 84" |
| Weight** | 580 lbs |

†Depth does not include 2 7/8" for door handle.
 **Because of the weight of this unit, it is recommended to consult a flooring expert prior to installation. The flooring beneath the unit should be rated to support at least 150 pounds per square foot.